

Presetting range of powRgrip® collets

D	D	PG 6/-CF		PG 6-S		PG 10/-CF		PG 10-S		PG 15/-CF		PG 15-S		PG 15-L**		PG 25/-CF	
		L [mm]		L [mm]		L [mm]		L [mm]		L [mm]		L [mm]		L [mm]		L [mm]	
[mm]	[inch]	min.	max.	min.	max.	min.	max.	min.	max.	min.	max.	min.	max.	min.	max.	min.	max.
0.2-1.0	-	21.5*	26.5*	-	-	20*	24*	-	-	-	-	-	-	-	-	-	-
1.5	-	23.5*	26.5*	-	-	16*	20*	-	-	-	-	-	-	-	-	-	-
-	1/16"	23.5*	26.5*	-	-	16*	20*	-	-	-	-	-	-	-	-	-	-
2.0	-	24	26.5	-	-	25	30	-	-	-	-	-	-	-	-	-	-
2.5	-	24*	26.5*	-	-	25	30	-	-	-	-	-	-	-	-	-	-
3.0	-	24	26.5	17	20	25	30	20.5	26	25	30	-	-	-	-	25	32.5
-	1/8"	24*	26.5*	17	20	25	30	20.5	26	25	30	18	25	-	-	25	35.2
3.5	-	-	-	-	-	25	30	-	-	25*	30*	-	-	-	-	25*	35.2*
4.0	-	-	-	-	-	25	30	20.5	26	25	30	18	25	25	53	25	35.2
4.5	-	-	-	-	-	25	30	-	-	25*	30*	-	-	-	-	25*	35.2*
-	3/16"	-	-	-	-	25	30	20.5	26	25	30	18	25	-	-	25	35.2
5.0	-	-	-	-	-	25	30	-	-	25	30	18	25	25	53	25	35.2
5.5	-	-	-	-	-	25	30	-	-	25*	30*	-	-	-	-	25*	35.2*
6.0	-	-	-	-	-	30	35	-	-	33	38	26	33	33	53	33	40.5
-	1/4"	-	-	-	-	30	35	23.5	29	33	38	26	33	33	53	33	40.5
7.0	-	-	-	-	-	-	-	-	-	33	38	-	-	-	-	33	40.5
-	5/16"	-	-	-	-	-	-	-	-	33	38	26	33	33	53	33	40.5
8.0	-	-	-	-	-	-	-	-	-	33	38	26	33	33	53	33	40.5
9.0	-	-	-	-	-	-	-	-	-	33	38	-	-	-	-	33	40.5
-	3/8"	-	-	-	-	-	-	-	-	37	40.5	31	38	37	53	37	44.5
10.0	-	-	-	-	-	-	-	-	-	37	40.5	31	38	37	53	37	44.5
11.0	-	-	-	-	-	-	-	-	-	-	-	-	-	-	-	37	44.5
-	7/16"	-	-	-	-	-	-	-	-	-	-	-	-	-	-	37	44.5
12.0	-	-	-	-	-	-	-	-	-	-	-	-	-	-	-	42	49.5
-	1/2"	-	-	-	-	-	-	-	-	-	-	-	-	-	-	42*	49.5*
13.0	-	-	-	-	-	-	-	-	-	-	-	-	-	-	-	42	49.5
14.0	-	-	-	-	-	-	-	-	-	-	-	-	-	-	-	42	49.5
-	9/16"	-	-	-	-	-	-	-	-	-	-	-	-	-	-	42	49.5
15.0	-	-	-	-	-	-	-	-	-	-	-	-	-	-	-	42	49.5
-	5/8"	-	-	-	-	-	-	-	-	-	-	-	-	-	-	45.5	50
16.0	-	-	-	-	-	-	-	-	-	-	-	-	-	-	-	45.5	50
18.0	-	-	-	-	-	-	-	-	-	-	-	-	-	-	-	45.5	50
-	3/4"	-	-	-	-	-	-	-	-	-	-	-	-	-	-	47.5	50
20.0	-	-	-	-	-	-	-	-	-	-	-	-	-	-	-	47.5	50
22.0	-	-	-	-	-	-	-	-	-	-	-	-	-	-	-	-	-
-	7/8"	-	-	-	-	-	-	-	-	-	-	-	-	-	-	-	-
25.0	-	-	-	-	-	-	-	-	-	-	-	-	-	-	-	-	-
-	1"	-	-	-	-	-	-	-	-	-	-	-	-	-	-	-	-

* CF not available. ** PG-L without stop screw.

Presetting range of powRgrip® collets

D	D	PG 25-S		PG 25-L**		PG 32/-CF		PG 32-S		PG 32-L**	
		L [mm]	L [mm]	L [mm]	L [mm]	L [mm]	L [mm]	L [mm]	L [mm]	L [mm]	L [mm]
[mm]	[inch]	min.	max.	min.	max.	min.	max.	min.	max.	min.	max.
0.2-1.0	-	-	-	-	-	-	-	-	-	-	-
1.5	-	-	-	-	-	-	-	-	-	-	-
-	1/16"	-	-	-	-	-	-	-	-	-	-
2.0	-	-	-	-	-	-	-	-	-	-	-
2.5	-	-	-	-	-	-	-	-	-	-	-
3.0	-	-	-	-	-	-	-	-	-	-	-
-	1/8"	-	-	-	-	-	-	-	-	-	-
3.5	-	-	-	-	-	-	-	-	-	-	-
4.0	-	18	25	-	-	-	-	-	-	-	-
4.5	-	-	-	-	-	-	-	-	-	-	-
-	3/16"	-	-	-	-	-	-	-	-	-	-
5.0	-	-	-	-	-	-	-	-	-	-	-
5.5	-	-	-	-	-	-	-	-	-	-	-
6.0	-	26	33	33	65	33.5	40.9	-	-	-	-
-	1/4"	26	33	33	65	33.5	40.9	-	-	-	-
7.0	-	-	-	-	-	33.5	40.9	-	-	-	-
-	5/16"	26	33	33	65	33.5	40.9	-	-	-	-
8.0	-	26	33	33	65	33.5	40.9	-	-	-	-
9.0	-	-	-	-	-	33.5	40.9	-	-	-	-
-	3/8"	30	38	37	65	35.5	44.9	-	-	-	-
10.0	-	30	38	37	65	35.5	44.9	-	-	-	-
11.0	-	-	-	-	-	35.5	44.9	-	-	-	-
-	7/16"	-	-	-	-	35.5	44.9	-	-	-	-
12.0	-	35	43	42	65	40.5	49.9	32	40.5	40.5	69
-	1/2"	35	43	42	65	40.5	49.9	32	40.5	40.5	69
13.0	-	-	-	-	-	40.5*	49.9*	-	-	-	-
14.0	-	35	43	42	65	40.5	49.9	35	43	40.5	69
-	9/16"	-	-	-	-	40.5	49.9	-	-	-	-
15.0	-	-	-	-	-	40.5*	49.9*	-	-	-	-
-	5/8"	38	46	45.5	65	43.5	52.9	38	46	-	-
16.0	-	38	46	45.5	65	43.5	52.9	35	43.5	43.5	69
18.0	-	-	-	-	-	43.5	52.9	-	-	-	-
-	3/4"	40	47.5	47.5	65	45.5	54.9	37	45.5	45.5	69
20.0	-	40	47.5	47.5	65	45.5	54.9	37	45.5	45.5	69
22.0	-	-	-	-	-	45.5	54.9	-	-	-	-
-	7/8"	-	-	-	-	45.5	54.9	-	-	-	-
25.0	-	-	-	-	-	49.5	58	41	49.5	49.5	69
-	1"	-	-	-	-	49.5	58	41	49.5	49.5	69

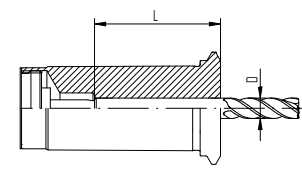

PG / PG-CF / PG-S / PG-L

* CF not available. ** PG-L without stop screw.

h6 shank tolerances

Metric	Tolerance	Minimum Size	Inch conversion
2.00	0.0060	1.9940	0.07850
3.00	0.0060	2.9940	0.11787
4.00	0.0080	3.9920	0.15717
5.00	0.0080	4.9920	0.19654
6.00	0.0080	5.9920	0.23591
7.00	0.0090	6.9910	0.27524
8.00	0.0090	7.9910	0.31461
9.00	0.0090	8.9910	0.35398
10.00	0.0090	9.9910	0.39335
11.00	0.0110	10.9890	0.43264
12.00	0.0110	11.9890	0.47201
13.00	0.0110	12.9890	0.51138
14.00	0.0110	13.9890	0.55075
15.00	0.0110	14.9890	0.59012
16.00	0.0110	15.9890	0.62949
17.00	0.0110	16.9890	0.66886
18.00	0.0110	17.9890	0.70823
19.00	0.0130	18.9870	0.74752
20.00	0.0130	19.9870	0.78689
22.00	0.0130	21.9870	0.86563
25.00	0.0130	21.9870	0.98374

Fractional	Decimal	Tolerance	Minimum Size
1/8	0.125	0.00024	0.12476
3/16	0.1875	0.00031	0.18719
1/4	0.250	0.00035	0.24965
5/16	0.3125	0.00035	0.31215
3/8	0.375	0.00035	0.37465
7/16	0.4375	0.00043	0.43707
1/2	0.500	0.00043	0.49957
9/16	0.5625	0.00043	0.56207
5/8	0.625	0.00043	0.62457
3/4	0.750	0.00051	0.74949
7/8	0.875	0.00051	0.87449
1	1.000	0.00051	.099949